

DETAIL-
SECTION THRU STONE
BENCHTOP

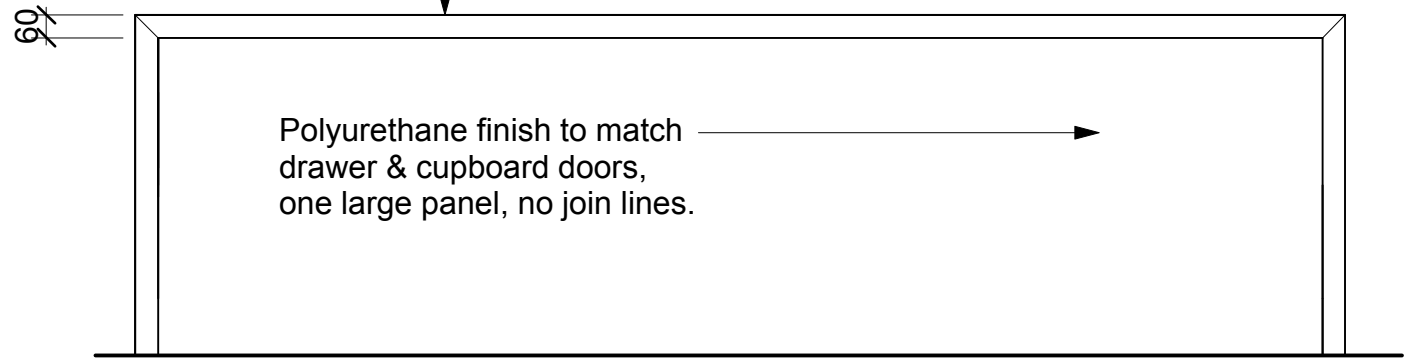

ELEVATION C- Stool side of island bench

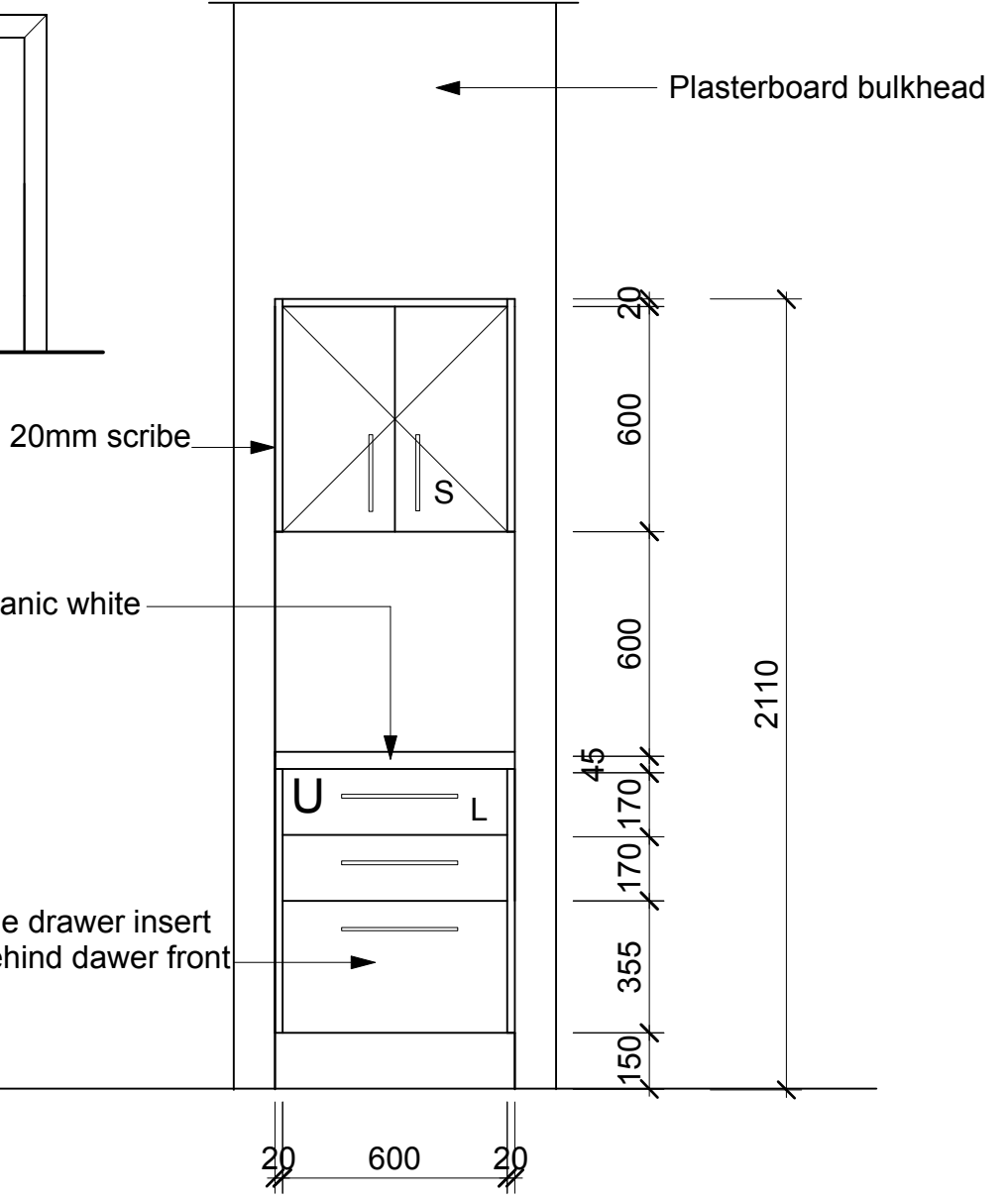

ELEVATION B

FINISHES & SPEC

- Doors, drawer fronts & external faces- Satin spray finish 2 pak polyurethane
- Carcase-16mm EO white melamine, matching 1mm white edging
- Drawers-Blum white tandembox drawers with soft close function, drawer base to be lined with grey non slip matting.
- Kickboard- brushed silver laminate, over flood compatible framework.
- Handles- Stainless steel D-pull, KETHY E2118/288 longer handles(L), KETHY E2118/192 shorter handles(S)
- Benchtop- Back bench- Stainless steel, Island bench Caesarstone, colour TBA

LEGEND

- C** Blum cutlery drawer inserts to suit drawer size
- U** Blum utensil drawer dividers to suit drawer size
- L** Refer to handle spec
- S** Refer to handle spec

C 29-7-2011 Preliminary